



Philips Medical Systems Easy Diagnostic Digital R/F SUITE

GENERAL NOTES

- ALL SPECIFICATIONS AND SPACE REQUIREMENTS ARE SHOWN GENERICALLY. CONTACT GAMMA TECHNOLOGIES FOR SPECIFIC REQUIREMENTS PERTAINING TO OPTIONAL EQUIPMENT COMPONENTS AND ADDITIONAL ROOM PREPARATION SPECIFICATIONS.

© PLANNING DIVISION
FILE NAME:
TYPICAL PHILIPS EASY DIAGNOSTIC
DIGITAL R/F
REVISION DATE: 09/23/03

EQUIPMENT SCHEDULE

EQUIPMENT IDENTIFICATION NUMBER

NOTES		BTU / HOUR	WEIGHT (LBS.)					
			DIMENSIONS (IN.)					
			W	x	D	x	H	
OFOI	1	171	PHILIPS MEDICAL SYSTEMS SUPER 80 CP OPERATORS COSOLE (COUNTER MOUNTED)		19.45	16.86	6.63	27
OFOI	2	2047	PHILIPS MEDICAL SYSTEMS SUPER 80 CP CONTROL CABINET		21.66	20.48	76.98	507
OFOI	3		PHILIPS MEDICAL SYSTEMS SUPER 80 CP GENERATOR CABINET		20.87	23.02	41.34	480
OFOI	4	1200	PHILIPS MEDICAL SYSTEMS PDU 6000 POWER DISTRIBUTION UNIT		21.62	20.51	44.01	548
OFOI	5	1878	PHILIPS MEDICAL SYSTEMS EASY DIAGNOST TABLE		144.90	65.75	115.96	2985
OFOI	6	2560	PHILIPS MEDICAL SYSTEMS EASY DIAGNOST R RACK		21.66	20.48	76.98	506
OFOI	7	1707	PHILIPS MEDICAL SYSTEMS BUCKY DIAGNOST CS4 OVERHEAD TUBE CRANE		169.29	160.470	110.24	941
OFOI	8	200	PHILIPS MEDICAL SYSTEMS BUCKY DIAGNOST VE VERTICAL BUCKY STAND		24.61	16.73	87.80	352
OFOI	9	170	PHILIPS MEDICAL SYSTEMS FLUORO MONITOR ON MOBILE CART		22.00	25.59	76.77	257
OFOI	10	2730	PHILIPS MEDICAL SYSTEMS DSI CONTROL CABINET		21.66	20.48	76.98	410
OFOI	11	140	PHILIPS MEDICAL SYSTEMS DSI MONITOR		14.19	13.78	12.60	36
OFOI	12		PHILIPS MEDICAL SYSTEMS DSI KEY BOARD		23.75	8.50	3.00	
OFOI	13	N/A	PHILIPS MEDICAL SYSTEMS DSI INFRARED RECEIVER		3.94	3.94	-	1
OFOI	14	N/A	PHILIPS MEDICAL SYSTEMS DSI REMOTE CONTROL		1.69	7.88	0.94	.5
OFOI	15	1030	UNINTERRUPTIBLE POWER SUPPLY		10.00	25.49	25.21	275

NOTE EXPLANATION: CFCI = CONTRACTOR FURNISHED - CONTRACTOR INSTALLED
OFCI = OWNER FURNISHED - CONTRACTOR INSTALLED
OFOI = OWNER FURNISHED - OWNER INSTALLED

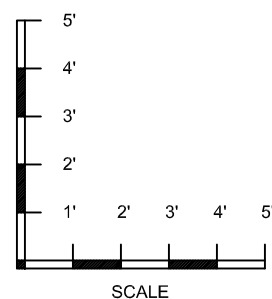
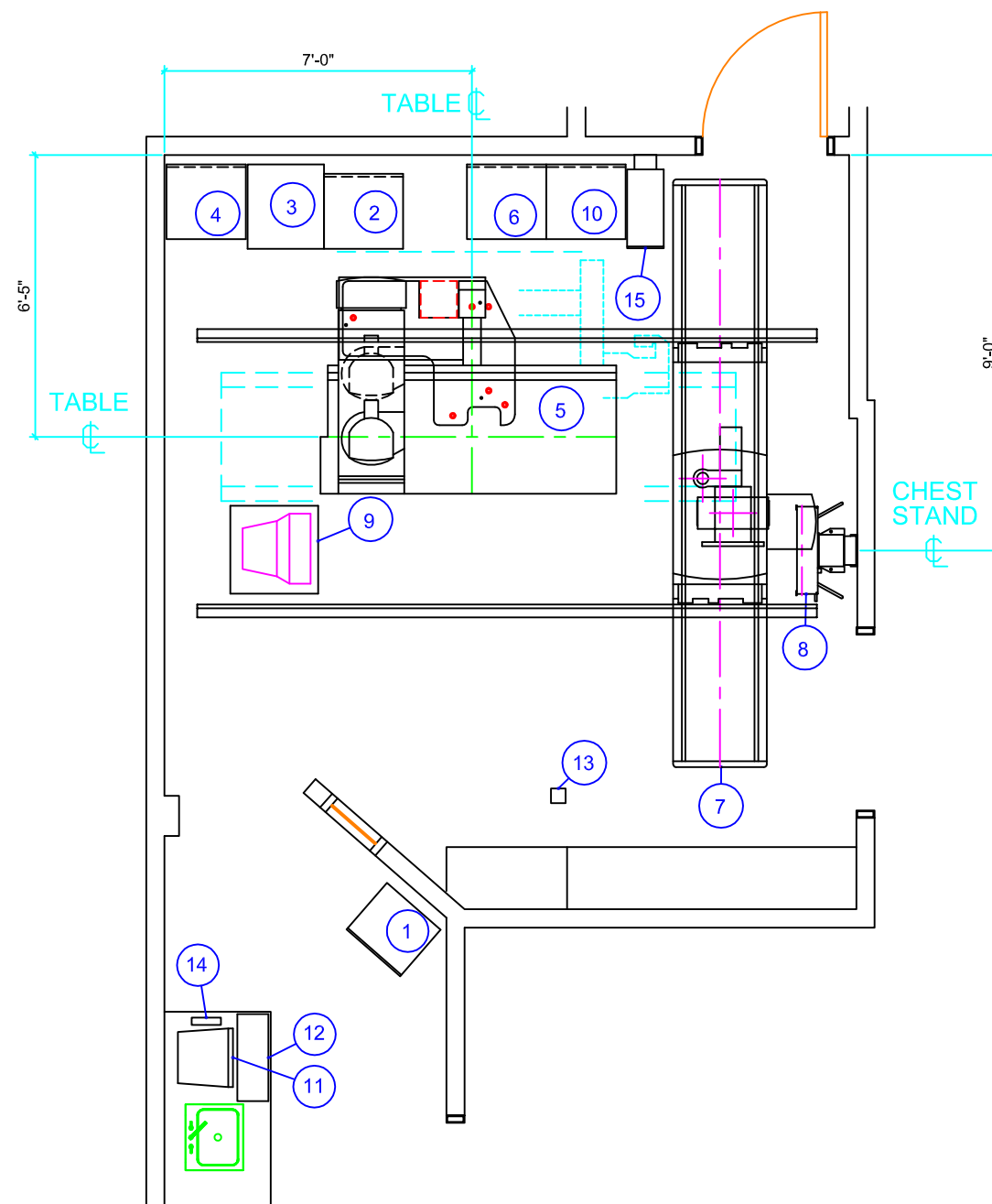

PLANNING BY:



GAMMA TECH, INC

129 Wild Berry Lane
Hampstead, NC 28443
Ph (910) 270-9787 • Fax (910) 270-9767
www.gammatech.net