

GENERAL NOTES

- ALL SPECIFICATIONS AND SPACE REQUIREMENTS ARE SHOWN GENERICALLY. CONTACT GAMMA TECH, INC FOR SPECIFIC REQUIREMENTS PERTAINING TO OPTIONAL EQUIPMENT COMPONENTS AND ADDITIONAL ROOM PREPARATION SPECIFICATIONS.
- RECOMMENDED FINISHED CEILING HEIGHT IS 10'-8".
- MAGNET ROOM TEMPERATURE: 59° TO 69.8° F. CONTROL AND EQUIPMENT ROOM TEMPERATURE: 59° TO 69.6° F. HUMIDITY: 30% TO 60% (NON-CONDENSING). ALLOWABLE TEMPERATURE CHANGE: 5°F PER HOUR. ALLOWABLE HUMIDITY CHANGE: 5% PER HOUR. MAXIMUM ROOM GRADIENT: 5°.
- MAXIMUM ALTITUDE: 8,000FT ABOVE SEA LEVEL. MINIMUM ALTITUDE: 100FT BELOW SEA LEVEL.
- MAIN INCOMING POWER SUPPLY: 480VAC, THREE PHASE, 150KVA, WYE OR DELTA (GROUNDED) CONNECTED, 90AMP, 3 POLE, MAIN CB, 4% VOLTAGE REGULATION, 90% POWER FACTOR

PLANNING DIVISION

FILE NAME:
GE SIGNA LX HISPEED

REVISION DATE:
07.15.2008

- THE ISOGAUSS CONTOUR PLOTS DEPICTED REPRESENT MAGNETIC FRINGE FIELDS RESULTING FROM THE NORMAL OPERATION OF THE MAGNET PROVIDED WITH THE MR SYSTEM. THE ACTUAL MAGNETIC FIELD INTENSITY AT ANY POINT IN THE VICINITY OF THE MAGNET WHEN INSTALLED MAY VARY FROM THE CONTOUR PLOTS DUE TO FACTORS SUCH AS THE CONCENTRATING EFFECTS OF NEARBY FERROUS OBJECTS AMBIENT MAGNETIC FIELDS, INCLUDING THE EARTH'S MAGNETIC FIELD. THEREFORE, THE CONTOURS SHOWN ARE ONLY APPROXIMATIONS OF ACTUAL FIELD INTENSITIES FOUND AT A CORRESPONDING DISTANCE FROM THE MAGNET'S ISOCENTER.
- FOR ACTIVELY SHIELDED MAGNETS THE POTENTIAL EXIST UNDER FAULT CONDITIONS THAT THE 5 GAUSS LINE MAY EXPAND RADICALLY FOR 2 SECONDS OR LESS.

MAGNETIC INTERFERENCE SPECIFICATIONS

- THE CUSTOMER MUST ESTABLISH PROTOCOLS TO PREVENT PERSONS WITH CARDIAC PACEMAKERS, NEUROSTIMULATORS, AND BIOSTIMULATION DEVICES FROM ENTERING MAGNETIC FIELDS OF GREATER THAN 5 GAUSS (EXCLUSION ZONE).
- MAIN POWER TRANSFORMERS MUST REMAIN OUTSIDE THE 3 GAUSS FIELD.
EMI < 40mG AC, EMI < 4.43mG DC.
- POTENTIAL EXISTS UNDER FAULT CONDITIONS THAT THE 5 GAUSS LINE MAY EXPAND 15.4 FT. (5.0 m) AND AXIALLY 22.36 FT. (7.0 m) FOR 2 SECONDS OR LESS. IT SHOULD BE NOTED THAT NORMAL RAMPDOWNS OR MRU (MAGNET RUNDOWN UNIT) INITIATED QUENCHES WILL NOT CAUSE THE MAGNETIC FIELD TO EXPAND.
- IT IS RECOMMENDED EVERY SITE CONSIDER THE EVENT OF A QUENCH AND PLAN ACCORDINGLY (SUCH AS PLACING 5 GAUSS WARNING SIGNS AT EXPANDED LOCATIONS).
- THE FERROUS METAL OBJECTS LISTED BELOW MUST NOT MOVE INTO OR INSIDE OF THE MOVING METAL SENSITIVITY LINE DURING SCANS.

TYPICAL MOVING MAGNETIC MASS	DISTANCE RADIIALLY	DISTANCE AXIALLY
CARTS, GURNEYS 100-400 LBS (45-182 KG)	3 GAUSS LINE	3 GAUSS LINE
FORKLIFTS, SMALL ELEVATOR, CARS, MINIVANS VANS, PICKUP TRUCKS, AMBULANCES (OBJECTS GREATER THAN 400 LBS (182 KG))	15.5 ft. [4.72 m]	21.0 ft. [6.4 m]
BUSES AND TRUCKS (DUMP, TRACTOR TRAILER, UTILITY, FIRE TRUCKS)	18.1 ft. [5.52 m]	24.5 ft. [7.47 m]

MRI SITE PLANNING REMINDERS

- THE LAYOUT SHOULD BE ARRANGED SO THAT THE 5G LINE IS CONTAINED TO THE MAGNET ROOM, IF NOT POSSIBLE, A BARRIER IS RECOMMENDED TO PREVENT ENTRY TO THE 5G FIELD AREA.
- THE SPACES AROUND, ABOVE, AND BELOW THE MAGNET MUST BE REVIEWED FOR EFFECTS OF THE 5G, 3G, 1G, AND .5G FIELDS. REFER TO THE PROXIMITY LIMIT CHART IN THE MR SITE PLANNING DIRECTION.
- FOR MOVING METAL, THE RESTRICTION LINES TYPICALLY EXTEND OUTSIDE OF THE MRI SPACE. PLEASE CONFIRM THERE ARE NO MOVING METAL CONCERNS WITHIN THESE AREAS. AN EMI STUDY IS RECOMMENDED IF THE RESTRICTION LINES ARE VIOLATED.
- FOR VIBRATION, PLEASE CONFIRM THAT A VIBRATION STUDY HAS BEEN RECOMMENDED AND/OR SUCCESSFULLY COMPLETED.
- FOR EMI, PLEASE REVIEW THE SITE FOR THE LOCATION OF THE MAIN ELECTRICAL FEEDERS, AC DEVICES, OR DISTRIBUTION SYSTEMS. AN EMI STUDY IS RECOMMENDED IF LARGE AC SYSTEMS ARE NEARBY.
- DETAILS OF THE FLOOR BELOW THE MAGNET SHOULD BE REVIEWED. THE STRUCTURAL ENGINEER MUST VERIFY THAT THE QUANTITY OF STEEL IN THE VOLUME 10FT (3.1M) X 10FT (3.1M) X 1FT (.3M) DEEP (BELOW THE MAGNET) DOES NOT EXCEED THE ALLOWABLE STEEL CONTENT AS GIVEN IN THE MR SITE PLANNING DIRECTION.

RESPONSIBILITY FOR THE COORDINATION, DESIGN, ENGINEERING, AND SITE PREPARATION RESIDES WITH THE CUSTOMER AND THEIR PROJECT ARCHITECTS AND CONTRACTORS. THE GE EQUIPMENT SUPPLIER OR THEIR PLANNER DOES NOT, BY PROVIDING REVIEWS AND FURNISHING COMMENTS AND ASSISTANCE, ACCEPT ANY RESPONSIBILITY BEYOND ITS OBLIGATIONS AS DEFINED IN THE MR SYSTEM, SALE/PURCHASE AGREEMENT.

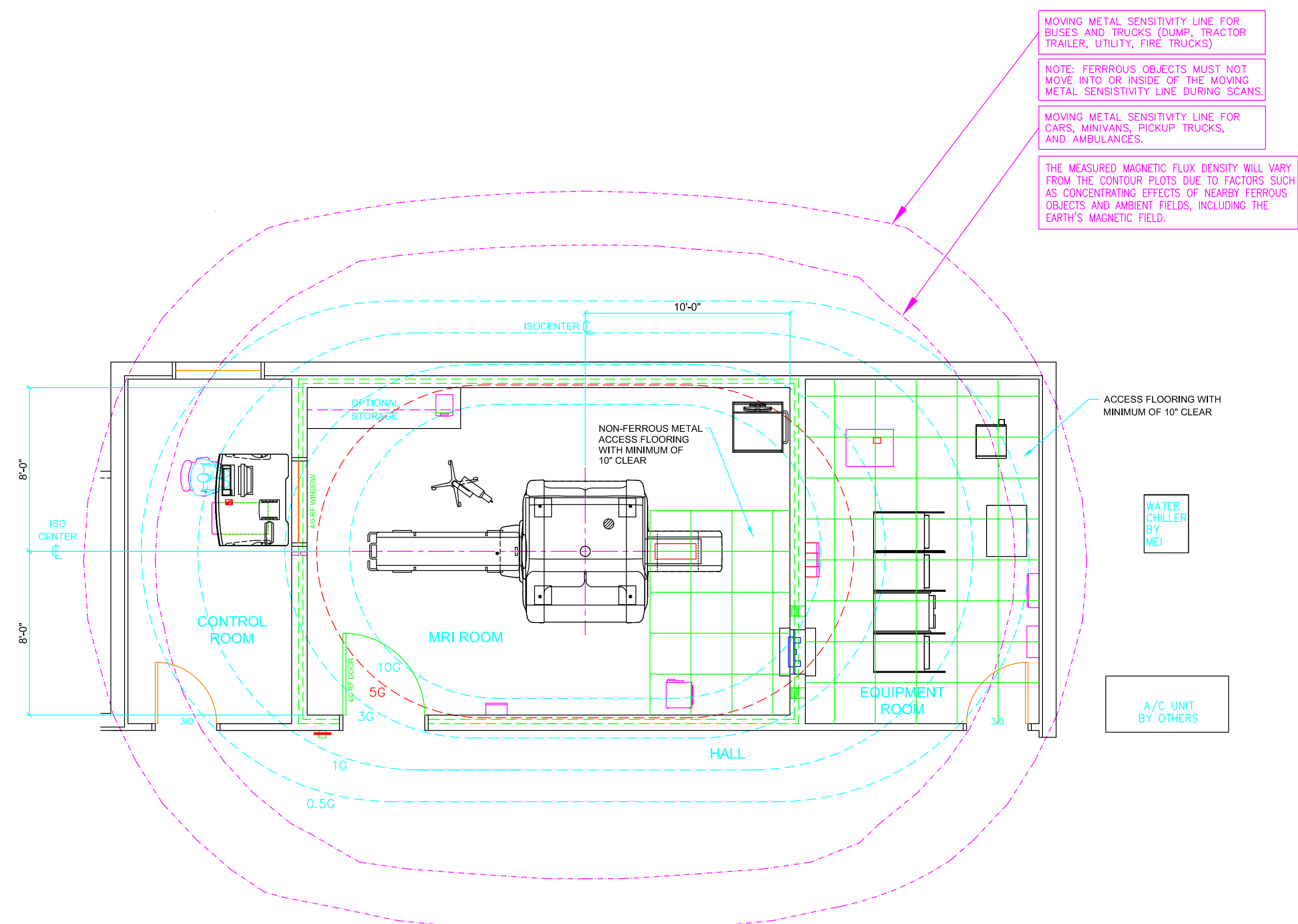

ISOGAUSS CONTOUR PLOTS
THIS LAYOUT MAY REQUIRE MAGNETIC SHIELDING SHIELDING BY OTHERS TO CONTAIN 5G LINE AT WALLS. FERROUS OBJECTS WILL INTERFERE WITH MAGNET OPERATION. FOR THIS REASON, ALL STRUCTURAL SUPPORT MEMBERS AND FLOOR MATERIALS MUST BE NON-FERROUS.

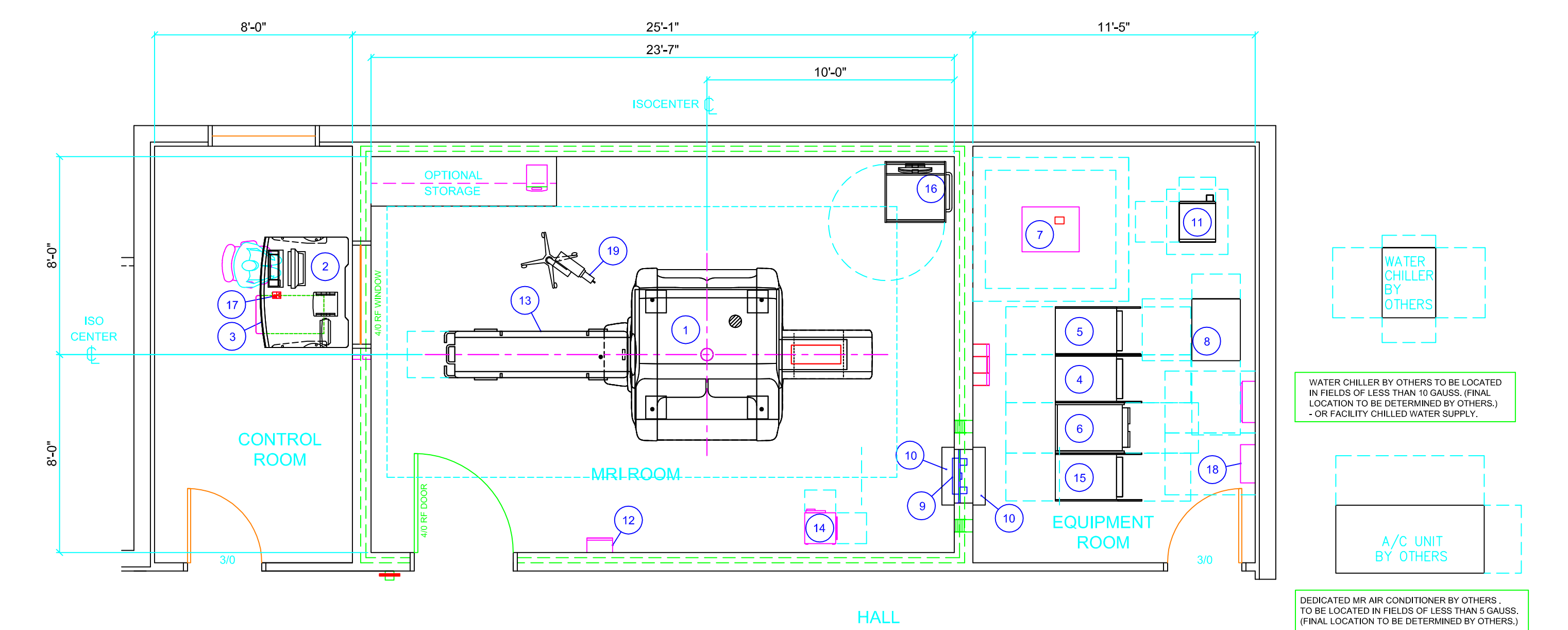

TYPICAL ROOM AND EQUIPMENT LAYOUT
(DASHED LINES DEPICT EQUIPMENT TRAVEL AND SERVICE CLEARANCES) (RECOMMENDED FINISHED CEILING HEIGHT = 10'-8")
THE ABILITY OF THE EXISTING FLOOR AND STRUCTURAL SUPPORT MEMBERS TO PROPERLY SUPPORT THE MAGNET IS TO BE DETERMINED BY A STRUCTURAL ENGINEER.

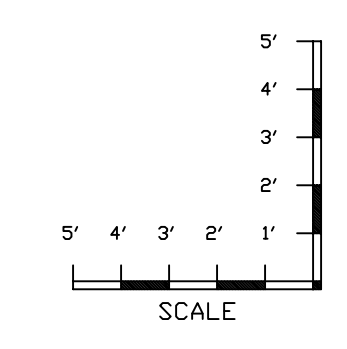

EQUIPMENT SCHEDULE

		BTU / HOUR		WEIGHT (LBS.)			
		DESCRIPTION		DIMENSIONS (IN.)			
		W	D	W	H		
1	12286	GENERAL ELECTRIC MEDICAL SYSTEMS SIGNA LX HISPEED 1.5 TESLA CX-K4 MAGNET - ACTIVE SHIELD	MS 1	83.27	75.19	101.86	12832
2	5051	GENERAL ELECTRIC MEDICAL SYSTEMS SIGNA LX HISPEED OPERATOR WORKSPACE WITH COLOR LCD MONITOR	OW	54.00	43.00	51.00	275
3	N/A	GENERAL ELECTRIC MEDICAL SYSTEMS SIGNA LX HISPEED OPERATOR WORKSPACE CABINET		18.50	29.00	26.00	191
4	11945	GENERAL ELECTRIC MEDICAL SYSTEMS SIGNA LX HISPEED RF PENETRATION CABINET	MR 1	23.56	42.00	70.60	740
5	6143	GENERAL ELECTRIC MEDICAL SYSTEMS SIGNA LX HISPEED LX SYSTEM CABINET	MR 2	23.56	42.00	76.60	496
6	42663	GENERAL ELECTRIC MEDICAL SYSTEMS SIGNA LX HISPEED GRADIENT AMP CABINET	MR 3	24.12	42.00	78.00	1067
7	14000	GENERAL ELECTRIC MEDICAL SYSTEMS SIGNA LX HISPEED WATER CHILLER FOR BODY COIL	WC 1	21.75	27.75	36.75	375
8	7000	GENERAL ELECTRIC MEDICAL SYSTEMS SIGNA LX HISPEED COMPACT PDU WITH POWERTECH PLUS	PD	22.25	30.62	70.00	980
9	N/A	GENERAL ELECTRIC MEDICAL SYSTEMS SIGNA LX HISPEED PENETRATION PANEL	PP 1	20.00	5.25	63.00	53
10	N/A	GENERAL ELECTRIC MEDICAL SYSTEMS SIGNA LX HISPEED PENETRATION PANEL COVER					
11	N/A	GENERAL ELECTRIC MEDICAL SYSTEMS SIGNA LX HISPEED SHIELD COOLER CABINET	MS 5	22.68	17.72	26.93	275
12	N/A	GENERAL ELECTRIC MEDICAL SYSTEMS SIGNA LX HISPEED MAGNET RUNDOWN UNIT	MS 4	12.00	6.75	7.50	9
13	N/A	GENERAL ELECTRIC MEDICAL SYSTEMS SIGNA LX HISPEED PATIENT TRANSPORT TABLE		39.00	89.00	38.00	280
14	3412	GENERAL ELECTRIC MEDICAL SYSTEMS SIGNA LX HISPEED BLOWER BOX (GC TO VERIFY LOCATION)	MG 6	15.00	15.00	21.75	46
15	N/A	GENERAL ELECTRIC MEDICAL SYSTEMS SIGNA LX HISPEED GRAM CABINET	MR 7	23.30	42.00	77.60	1881
16	N/A	GENERAL ELECTRIC MEDICAL SYSTEMS SIGNA LX HISPEED SPT PHANTOM CABINET		29.50	31.00	58.50	351
17	N/A	GENERAL ELECTRIC MEDICAL SYSTEMS SIGNA LX HISPEED PATIENT ALERT CONTROL BOX	PA	4.00	3.00	2.50	0.5
18	204	GENERAL ELECTRIC MEDICAL SYSTEMS SIGNA MRI INFINITY MAGNET MONITOR		18.60	7.16	10.89	24
19	N/A	GENERAL ELECTRIC MEDICAL SYSTEMS SIGNA LX HISPEED INJECTOR HEAD/STAND UNIT					37