

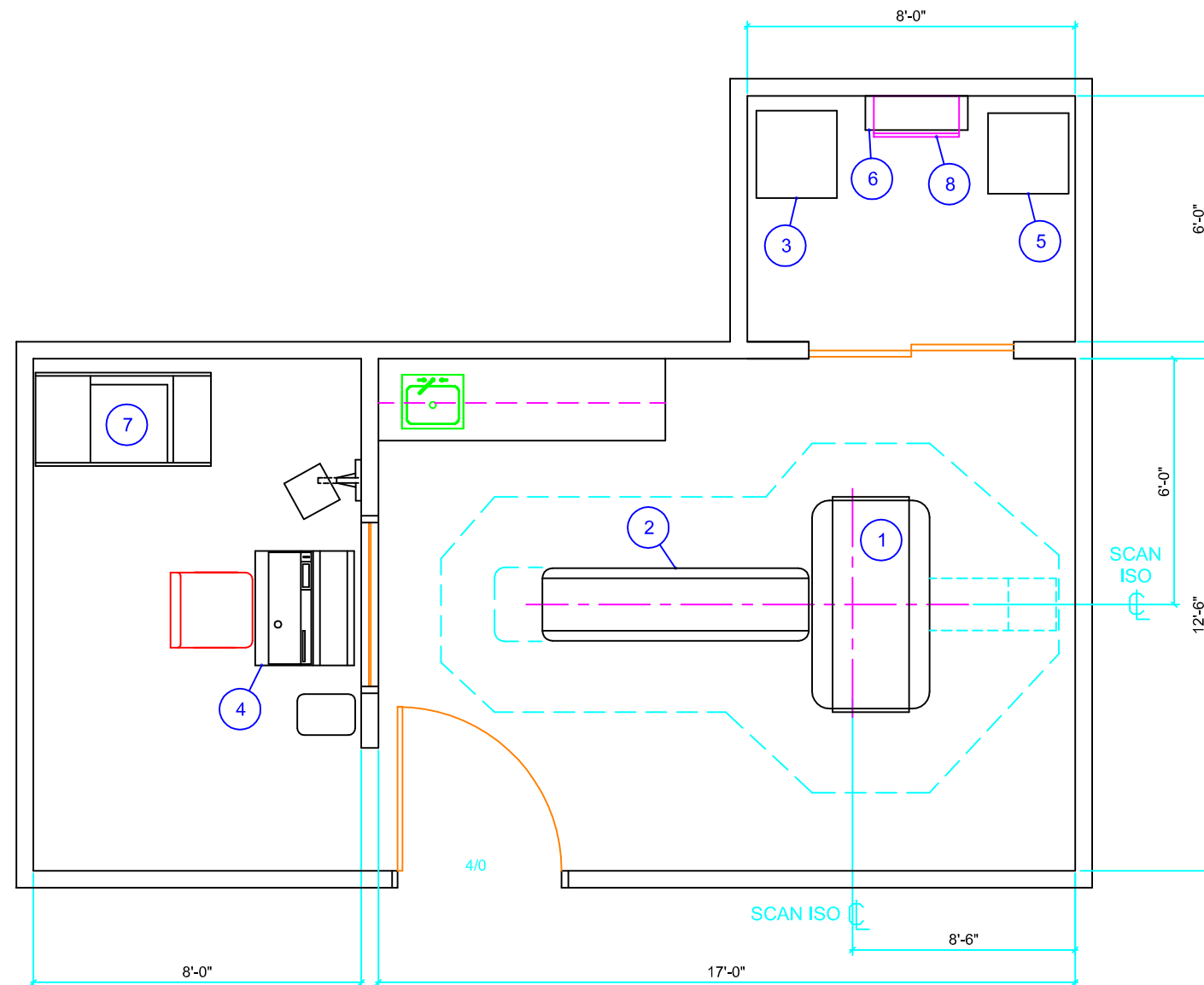

GE Medical Systems

CT MAX CT SCANNER



TYPICAL ROOM AND EQUIPMENT LAYOUT
(DASHED LINES DEPICT EQUIPMENT TRAVEL AND SERVICE CLEARANCES)
RECOMMENDED FINISHED CEILING HEIGHT = 8'-0"

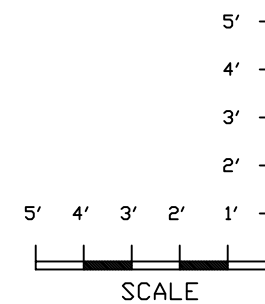

GENERAL NOTES

- ALL SPECIFICATIONS AND SPACE REQUIREMENTS ARE SHOWN GENERICALLY. CONTACT GAMMA TECH, INC. FOR SPECIFIC REQUIREMENTS PERTAINING TO OPTIONAL EQUIPMENT COMPONENTS AND ADDITIONAL ROOM PREPARATION SPECIFICATIONS.
- RECOMMENDED FINISHED CEILING HEIGHT IS 8'-0". MINIMUM FINISHED CEILING HEIGHT 7'-0".
- AMBIENT OPERATION TEMPERATURE: 71° TO 82° F. HUMIDITY: 20% TO 80% (NON-CONDENSING). ALLOWABLE TEMPERATURE CHANGE: 5°F PER HOUR. ALLOWABLE HUMIDITY CHANGE: 5% PER HOUR.
- MAX - ALTITUDE: 7500FT ABOVE SEA LEVEL

© PLANNING DIVISION

FILE NAME:
GE MAX

REVISION DATE:
01.22.2008

COMPONENT	POWER DEMAND		CURRENT (AMP)			
	MAX DEMAND (KVA)	VOLTAGE (NOM.)	MOMENTARY	LONG TIME	PHASE	REGULATION
PWR. DIST. UNIT	30	208			1	4

EQUIPMENT SCHEDULE				
EQUIPMENT IDENTIFICATION NUMBER				
NO.	DESCRIPTION	BTU / HOUR	WEIGHT (LBS.)	
			DIMENSIONS (IN.)	
			W	x D x H
1	GE MEDICAL SYSTEMS CT MAX GANTRY	2777		1168
2	GE MEDICAL SYSTEMS PATIENT TABLE	397		430
3	GE MEDICAL SYSTEMS H.V. TRANSFORMER	397		617
4	GE MEDICAL SYSTEMS OPERATOR'S CONSOLE	1984		342
5	GE MEDICAL SYSTEMS X-RAY CONTROLLER	1984		397
6	GE MEDICAL SYSTEMS POWER BOX DISTRIBUTION BOX			500
7	GE MEDICAL SYSTEMS LASER IMAGER SYSTEM	2220		686
8	POWERTECH SUPPRESSOR/FILTER	20		106

PLANNING BY:

GAMMA TECH, INC
129 Wild Berry Lane
Hampstead, NC 28443
Ph (910) 270-9787 • Fax (910) 270-9767
www.gammatech.net